

RVS 20000H

Data Sheet

Technical Data

| RVS 20000H | |
|--|---|
| Max. air volume on air + material inlet | 20,000 m ³ /h |
| Max. negative pressure | -15 kPa (1,500 mm WG) |
| Max. positive pressure paper/cardboard | 5 kPa |
| Max. positive pressure - plastic | 0 Pa |
| Motor/Gear | 3.0 kW / 11 RPM (50Hz) 14 RPM (60Hz) |
| Power supply | 3 x 230 / 400V (50Hz) |
| Amps | 10.5 / 6.0 A |
| Perforation in separation screen in the housing | Ø3 mm |
| Weight | 1,240 kg |
| Material amount (at 100 g/m ² or 100 µ)* | 4,000 kg/h* |
| Max. sound pressure level (1 m from unit, 1 m above floor) | 75 dB(A) |
| Normal operating temperature | -10°C to +50°C |
| Corrosion protection | Corrosion class C4 |
| Conditions - Installation | Indoors and Outdoors |
| Approval | Not ATEX approved |

*Material amount is a guideline, a verification from Kongskilde is required

Max. particle size: Max length of plastic film and paper piece is 600 mm. For thicker material (> 0,5 mm), max. length is 50 mm (diagonal).

Inlet and Outlet

| Transitions for material and inlet air | | Transitions for air outlet | |
|--|-----------------|----------------------------|-----------------|
| Pipe connection | Length, Surface | Pipe connection | Length, Surface |
| FK 300 | 990 mm, painted | FK 300 | 990 mm, painted |
| FK 400 | 990 mm, painted | FK 400 | 990 mm, painted |
| FK 500 | 990 mm, painted | FK 500 | 990 mm, painted |
| FK 700 | 2 mm, painted | FK 700 | n/a |
| FK 300 | 990 mm, galv. | FK 300 | 990 mm, galv. |
| FK 400 | 990 mm, galv. | FK 400 | 990 mm, galv. |
| FK 500 | 990 mm, galv. | FK 500 | 990 mm, galv. |

Back Pressure Diagram

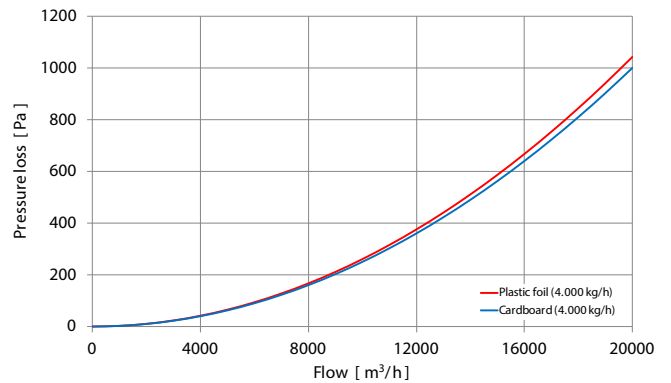

Air Leakage Diagram

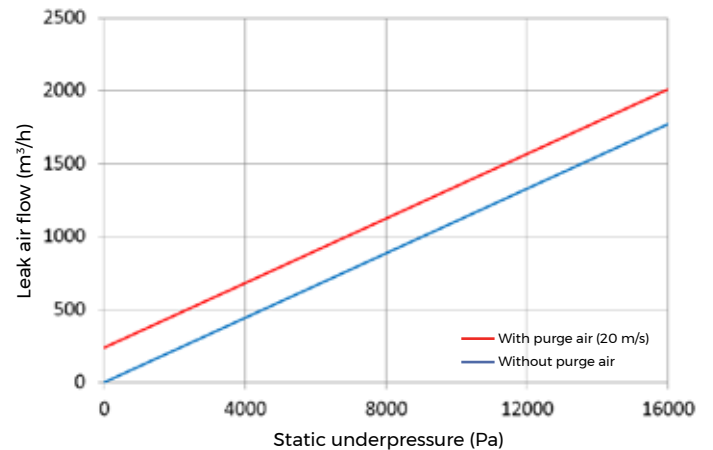

Purge air is used to ventilate the bearing room when running plastic material. The red curve (with purge air) is then used for leakage air when handling plastic material. The blue curve is only used when running paper and cardboard. The leakage air has to be added to the air flow of the separator inlet.



Dimensions RVS 20000H

Air and Material Inlet Side

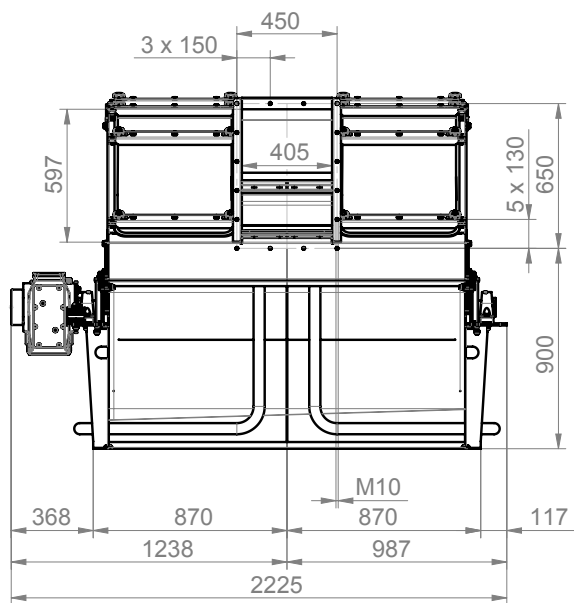

Side View Drive Side

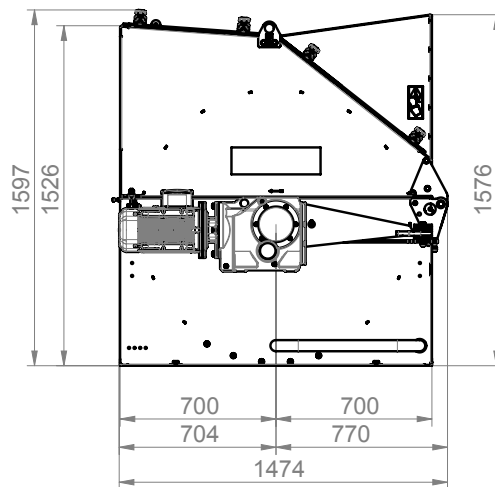

Air Outlet Side

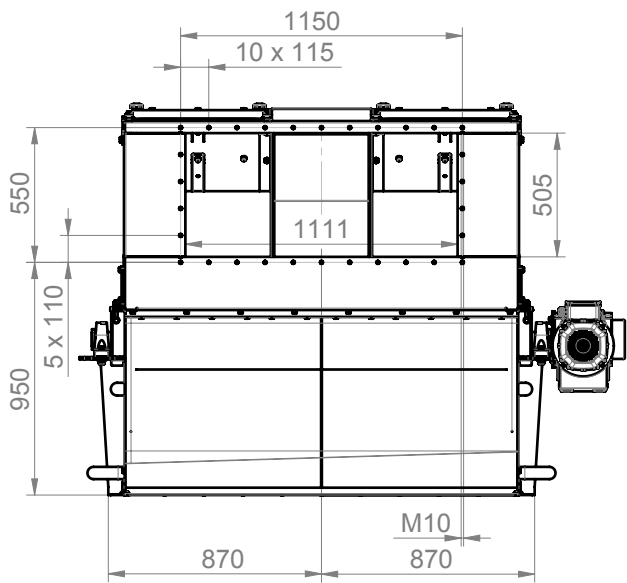

Bottom Material Outlet

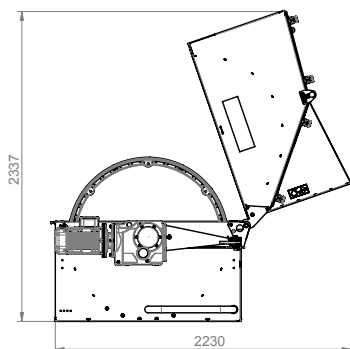
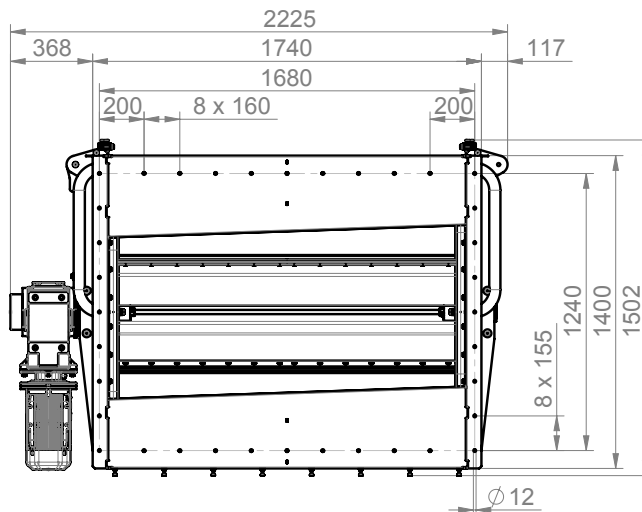

Subject to be changed without notice. 123001923 EXP/CB/RVS 20000H/DATA/0919

Kongskilde Industries A/S

Tel.: +45 72 17 60 50

industry@kongskilde-industries.com

www.kongskilde-industries.com

K KONGSKILDE
Air solutions / your success