

KG 3000

Data sheet

Kongskilde Inline Granulator KG 3000 have been developed specifically to granulate plastic foil and, thereby, enable process waste to be reclaimed and reintroduced directly into the production process.

Typical applications are in connection with film blowing machines and extruders. When using the inline granulator, the risk of material contamination is reduced.

The process waste is cut and conveyed in a closed pipe system, which keeps the dust level at a minimum.

Description

The granulator consists of a cast housing and a rotor with 2 or 6 rotating knives and a 180 degree screen. Screens are available in standard hole sizes: 1/8", 3/16", 1/4", 3/8", 1/2" and 1" mm.

The knives are supplied in standard hardened steel with good resistance to wear and extended service life. Tungsten carbide knives are also available for use with abrasive materials. These knives last normally approx. 10 times longer than the standard knives.

Function

When the continuous edge trim enters the granulator, it is cut until the pieces are small enough to pass through the holes in the screen. The screen is easily changed without dismantling the granulator. The top part of the housing is removed and the screens slide in behind the rotor. The granulator is mounted in an OK pipe system and is available with OK160 and 200 connections. The distance from pick up to granulator should not exceed 5m.

Application

The granulator is typically used in conjunction with film blowing machines where edge trim is generated.

The process waste is picked up by a suction system and taken through the granulator and directly back to the mixer on the film blowing machine. The processed material is then mixed with virgin material and re-used.



Technical Data

Minimum air flow: 500 cfm

Motor	2HP
Motor rpm	3,500
Running current	2.6 amp
Wiring	3x460V, 60 Hz 3x575V, 60 Hz
Weight incl. motor	
w. 2 blades	136 lbs
w. 6 blades	143 lbs
Noise level*)	89 dB (A)

*) The noise level is measured 1 m directly above the granulator.

Please note that noise transmitted through connecting piping is higher than indicated above. Noise reduction is possible by including blow through silencers in the pipe layout.

Sound enclosure for KG 3000 available as option.

Back pressure (with Material)

(inches WG)

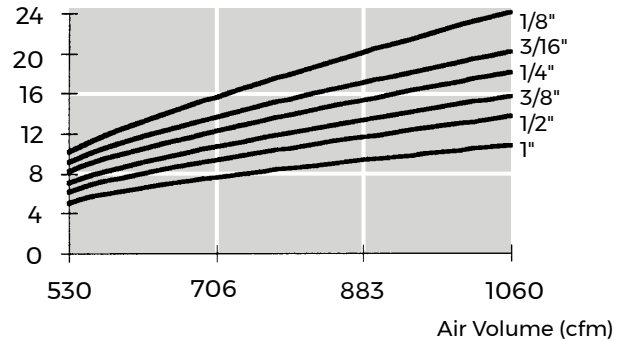

Capacity

(lbs/hr)

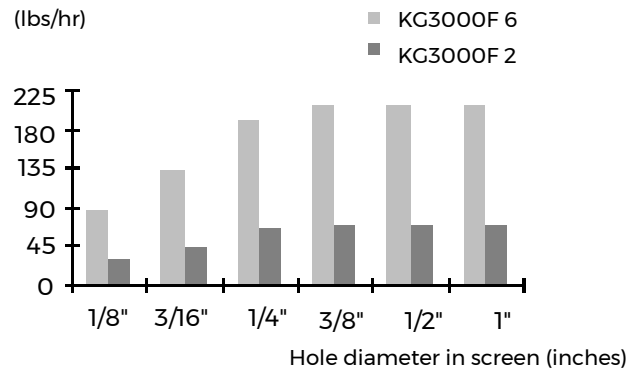

Capacity depends on kind of material and airflow through granulator. Stretch Film reduce capacity to approx. 1/3 of above.

Dimensions

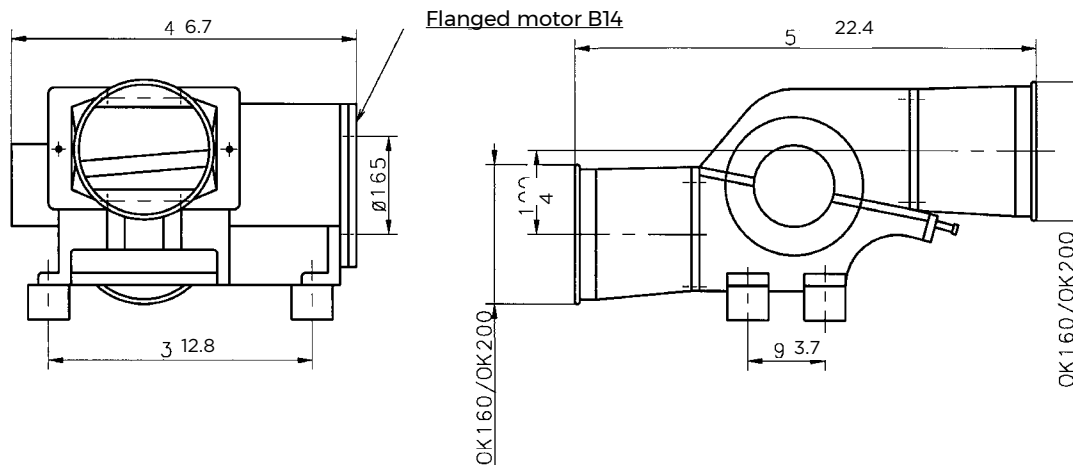

Kongskilde Industries USA Inc.

1802 Industrial Park Drive, Unit A
Normal, IL 61761

Tel.: (309) 452-3300

kna@kongskilde-industries.com

www.kongskilde-industries.com

