



Air solutions / your success

# KBE Bucket Elevator

## Technical specifications

Kongskilde KBE bucket elevator is designed for gentle grain conveying with low energy consumption. It is made in galvanised heavy-duty execution and thus suitable for outdoor installations.

The KBE bucket elevator is made in modular design with common parts for the 20 and 40 t/h models, 60 and 80 t/h models, 100 and 120 t/h models.

The KBE bucket elevators are available for capacities from 20 to 120 t/h. On request bucket elevators with capacities up to 300 t/h can be supplied.

### Specifications for KBE bucket elevator:

- Strong galvanised industrial quality
- Elevator boot designed for gentle inlet, equipped with mechanical belt tightening and clean-out door for manual inside cleaning.

- Shaft mounted gear motor
- Strong belt with high-capacity buckets, optional oil resistant belt
- Extension 2.5 m (with support), 1 m, 0.5 m and 0.25 m - other lengths on request.
- Back running stop preventing the elevator from running backwards. Back running stop is recommended as standard.

Max. lifting height (total height of the extensions): 24 m Kongskilde can also supply bucket elevators for heights above 24 m - ask for separate quotation.

### Accessories:

A large range of accessories is available for the KBE elevators.

Standard	KBE 20	KBE 40	KBE 60	KBE 80	KBE 100	KBE 120
Capacity t/h Density 0.75 t/m <sup>3</sup>	20	40	60	80	100	120
Buckets, qty./m belt	6	12	8	10.5	7.5	9
Belt width, mm	150	150	200	200	250	250
Elevator head plate thickness, mm	3	3	3	3	4/3	4/3
Elevator foot plate thickness, mm	3	3	3	3	4/3	4/3
Extensions, plate thickness, mm	1.5	1.5	1.5	1.5	1.5	1.5
Recommended outlet, mm	160	200	200	250	300	300

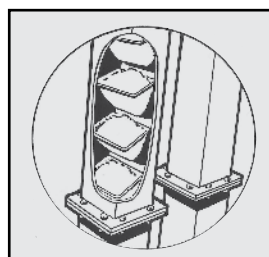

# Dimensional (mm)

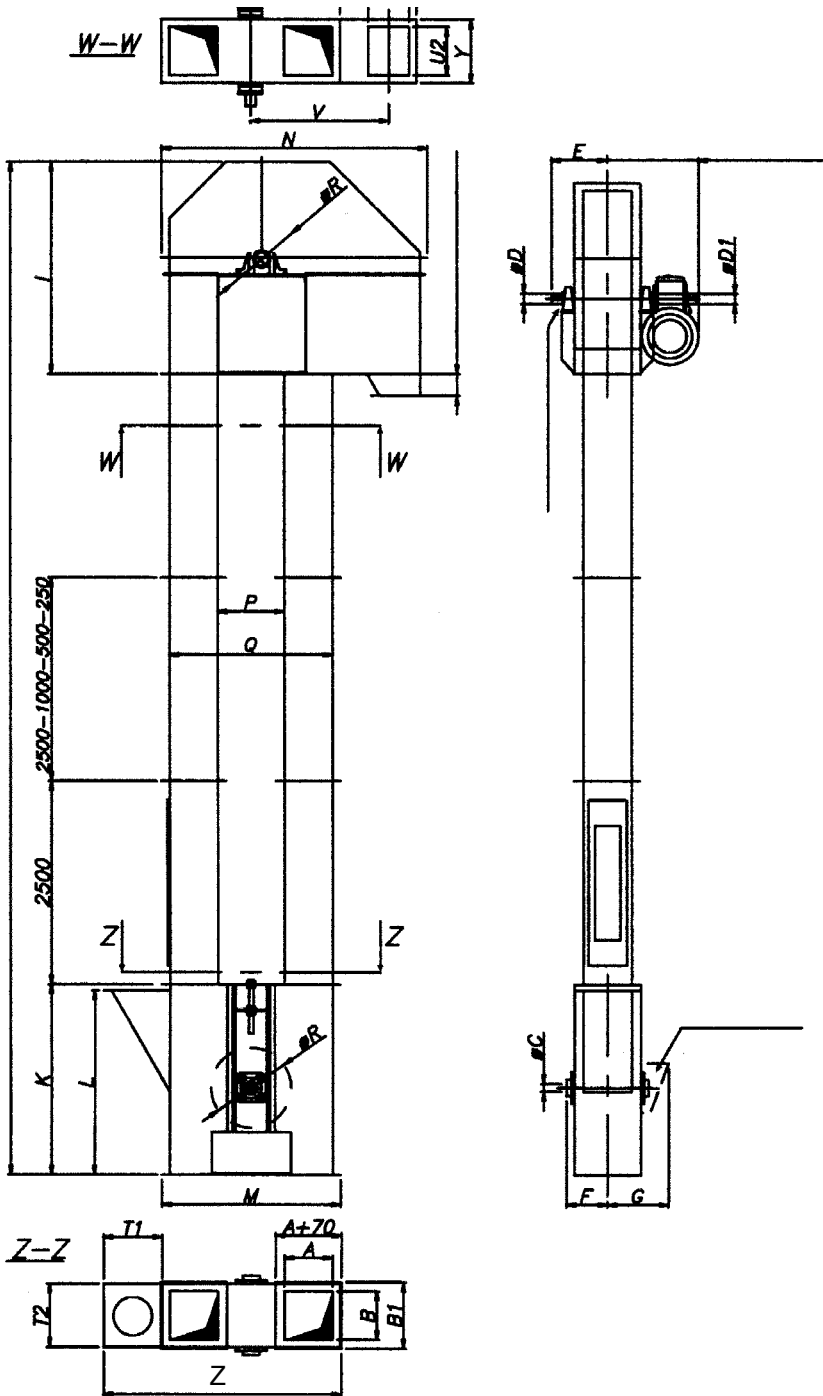

Type	KBE 20/40	KBE 60/80	KBE 100/120
A	210	225	240
B	210	285	330
B1	299	366	421
C	40	40	40
D	40	50	60
E	225	275	309
F	187	215	246
G	250	282	313
H	See below	See below	See below
I	840	979	1115
K	797	963	1088
L	767	933	1058
M	753	854	979
N	1060	1176	1316
P	275	347	442
Q	696	797	922
R	309	390	485
T1	254	305	384
T2	267	332	387
U1	207	222	237
U2	207	272	327
V	550	605	674
X	310	323	340
Y	327	392	459
D1	24	32	48
Z	983	1164	1339
Axel dia.	30	38	60
	38	48	

H = K + I + lifting height = total elevator height  
 Lifting height = total height/length of extensions

## KBE 20/40

Lifting height, m	10,00	11,00	12,50	13,50	15,00	17,50	20,00	21,00	22,00	23,00	24,00
Total height, m	11,64	12,64	14,14	15,14	16,64	19,14	21,64	22,64	23,64	24,64	25,64

## KBE 60/80

Lifting height, m	10,00	11,00	12,50	13,50	15,00	17,50	20,00	21,00	22,00	23,00	24,00
Total height, m	11,94	12,94	14,44	15,44	16,94	19,44	21,94	22,94	23,94	24,94	25,94

## KBE 100/120

Lifting height, m	10,00	11,00	12,50	13,50	15,00	17,50	20,00	21,00	22,00	23,00	24,00
Total height, m	12,20	13,20	14,70	15,70	17,20	19,70	22,20	23,20	24,20	25,20	26,20

## Service platform

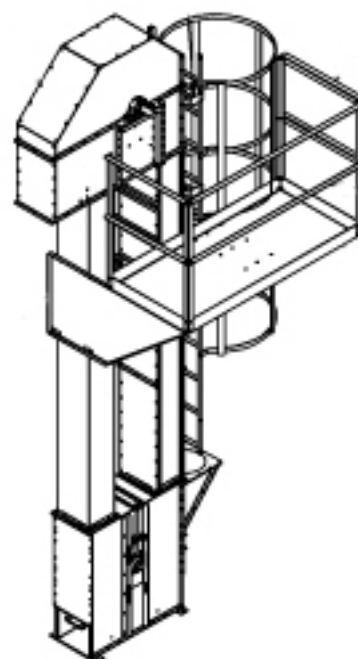
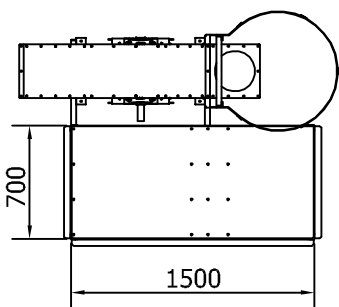
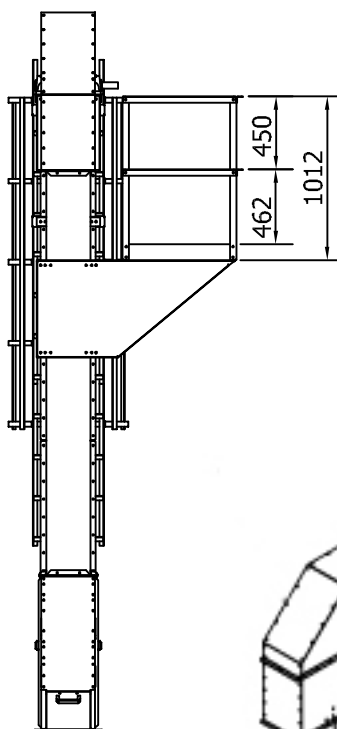
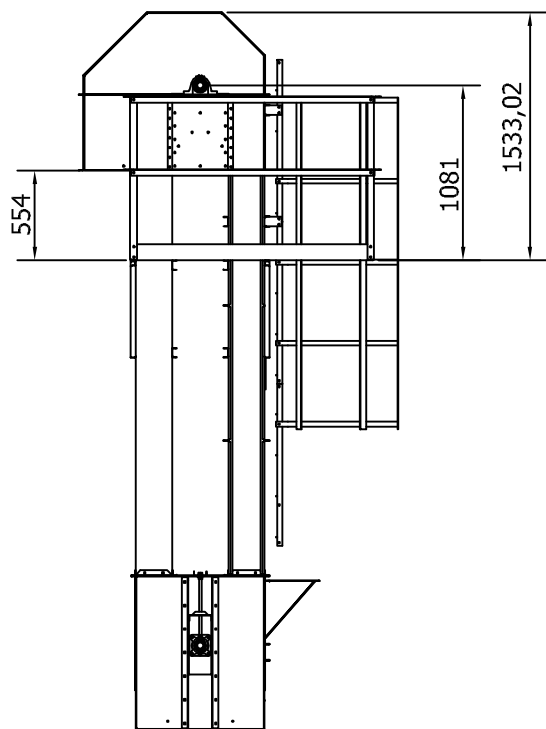

## Motor demand

Total length of extensions	Type		
	KBE 20/40	KBE 60/80	KBE100/120
10,0 m	1,5 kW / 3,0 kW	4,0 kW / 5,5 kW	7,5 kW / 9,2 kW
11,0 m	1,5 kW / 3,0 kW	5,5 kW / 7,5 kW	7,5 kW / 9,2 kW
12,5 m	1,5 kW / 4,0 kW	5,5 kW / 7,5 kW	7,5 kW / 9,2 kW
13,5 m	2,2 kW / 4,0 kW	5,5 kW / 7,5 kW	9,2 kW / 11,0 kW
15,0 m	2,2 kW / 4,0 kW	5,5 kW / 7,5 kW	9,2 kW / 11,0 kW
17,5 m	2,2 kW / 4,0 kW	7,5 kW / 7,5 kW	9,2 kW / 11,0 kW
20,0 m	2,2 kW / 4,0 kW	5,5 kW / 9,2 kW	11,0 kW / 15,0 kW

## Accessoires

- Rotation detector
- Back running stop
- Oil resistant belt
- Plast buckets
- Spacer for buckets (for seed transport)
- Spigot for dust extraction
- Shield for motor
- Shield for rotation detector
- Service platform single/double
- Ladder for service platform
- Adaptors for inlet and outlet

# KBE 20/40 - Accessories

136 000 490: OK160 Inlet adaptor

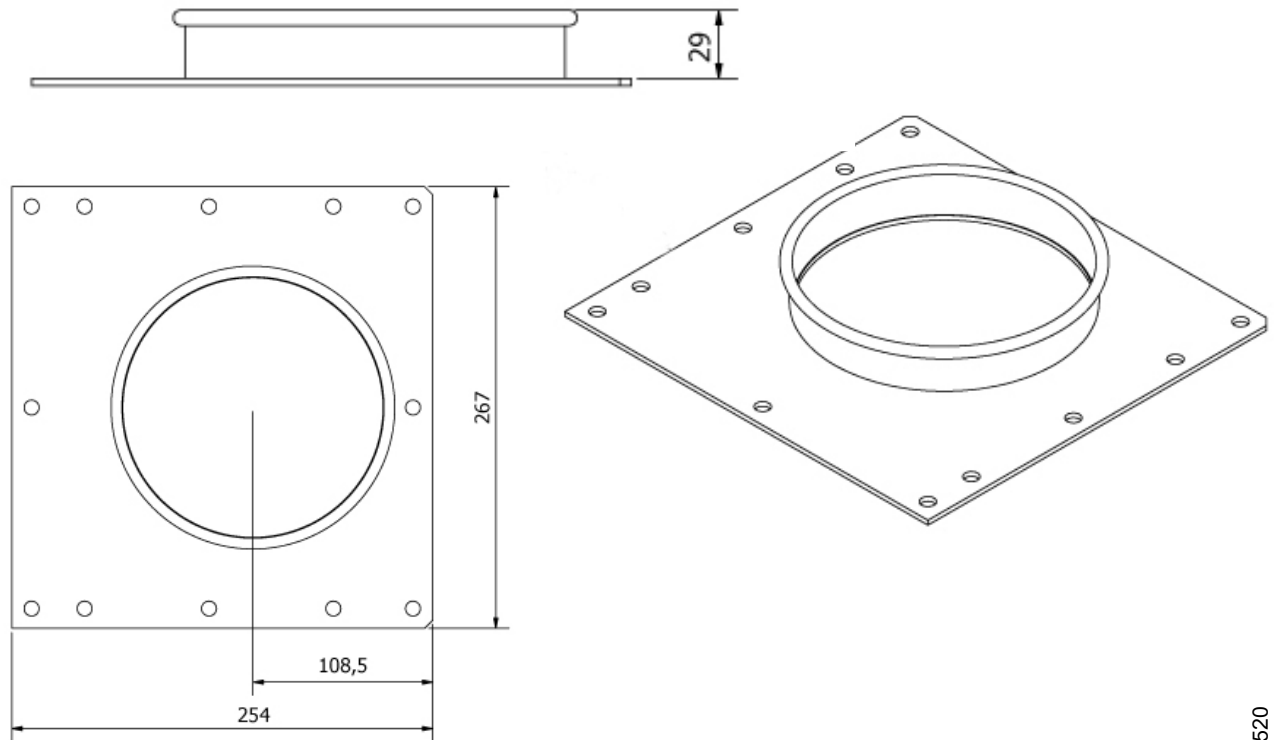

30-520

136 000 491: OK200 Inlet adaptor

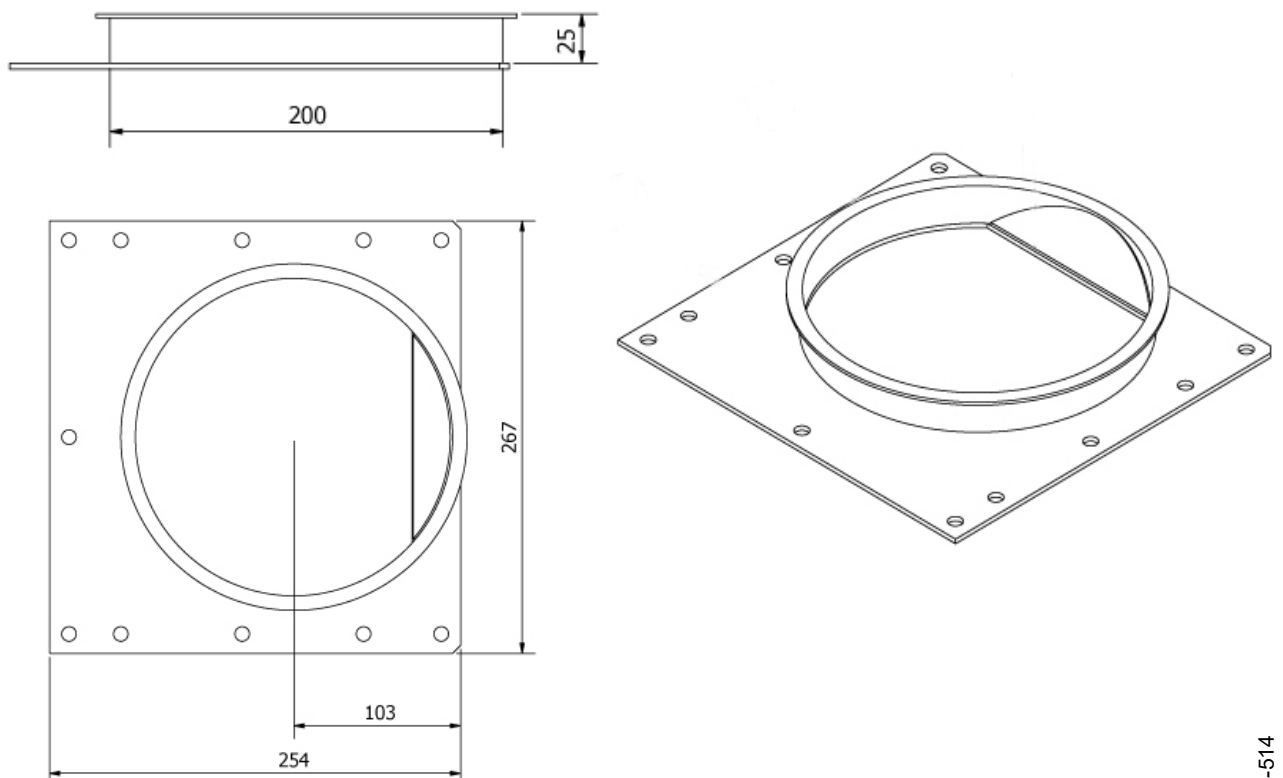

30-514

# KBE 20/40 - Accessories

**136 000 391: Hopper, 2-sided**

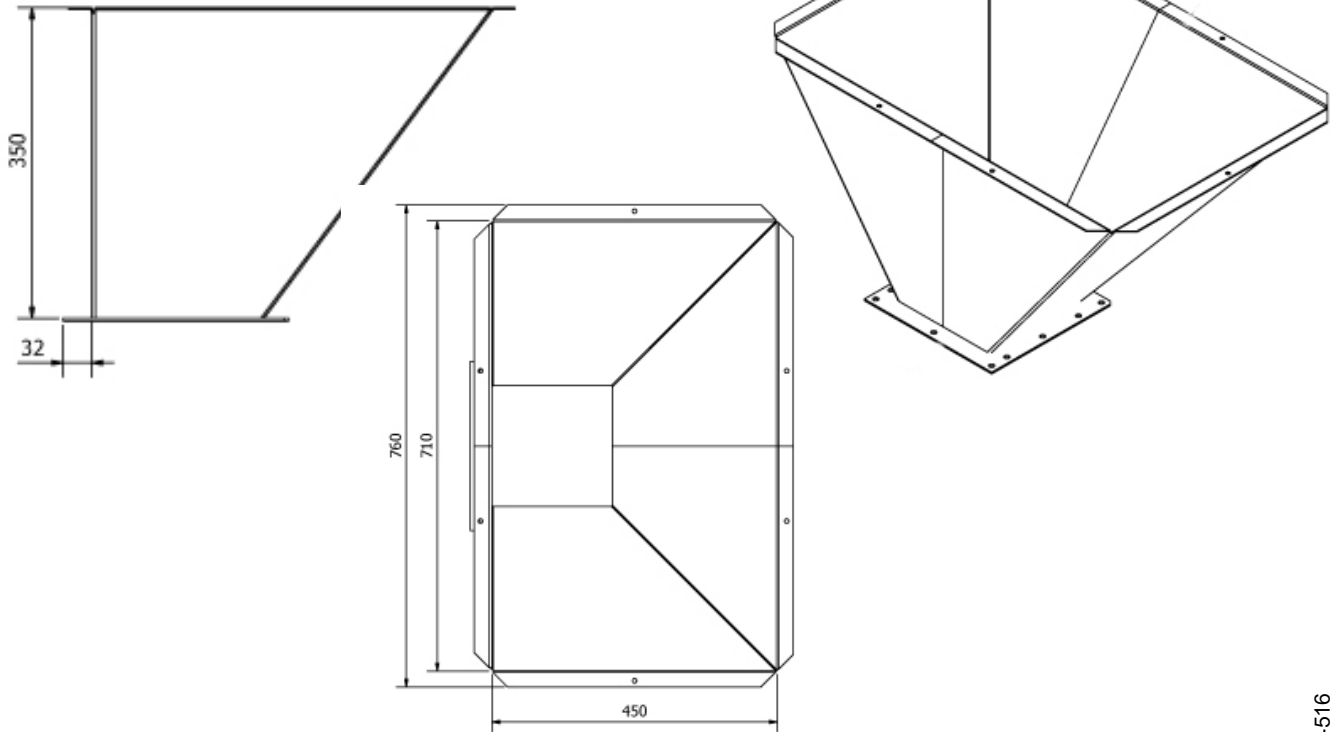

30-516

**136 000 392: Hopper, right (shown)**

**136 000 393: Hopper, left**

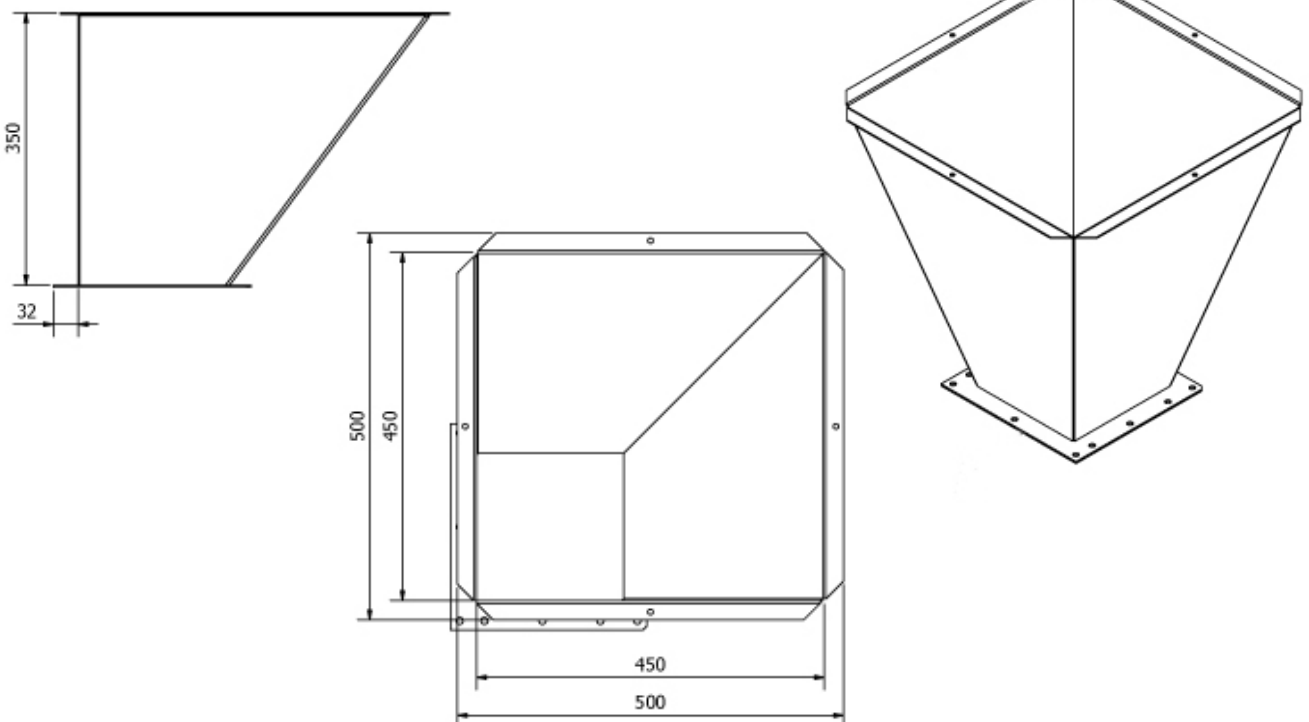

30-515

# KBE 20/40 - Accessories

136 000 394: OK160 transition, outlet adaptor

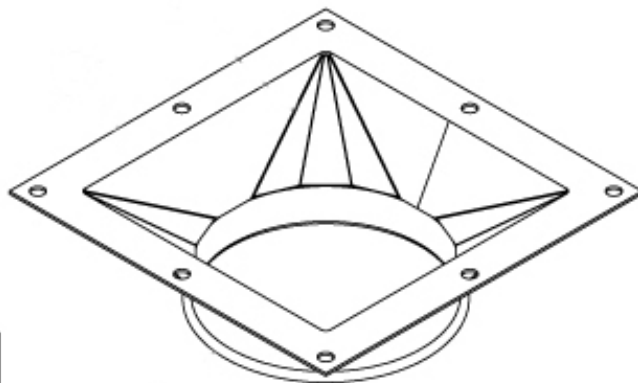
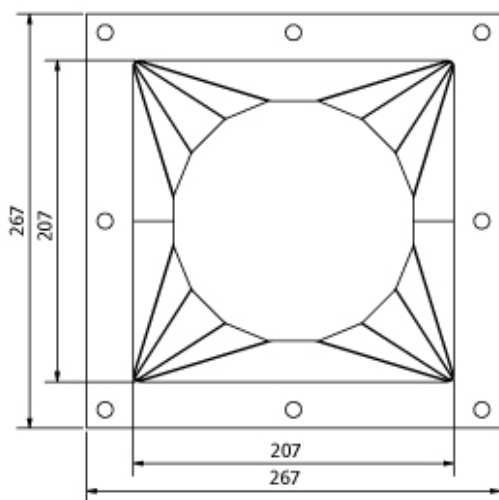
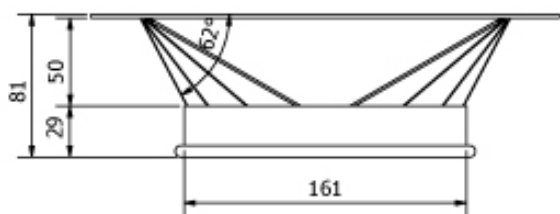

30-513

136 000 395: OK200 transition, outlet adaptor

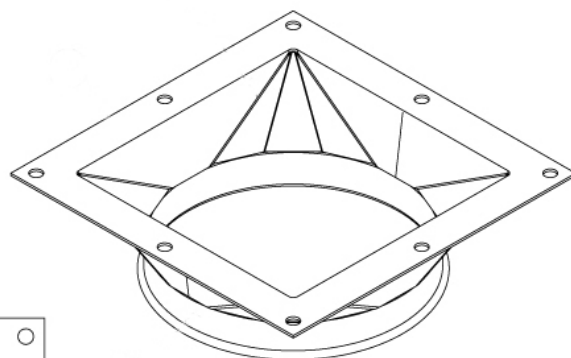
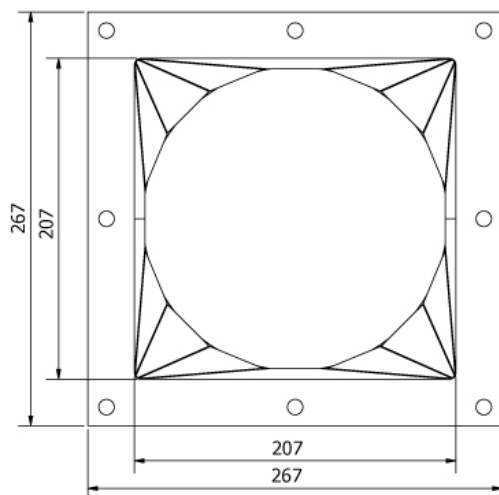
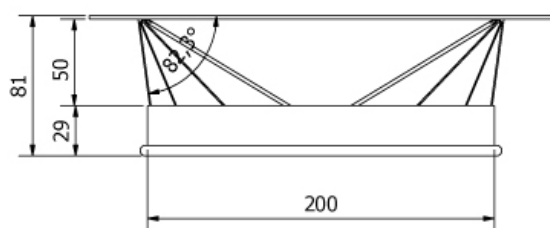

30-519

# KBE 60/80 - Accessories

136 000 492: OK200 Inlet adaptor

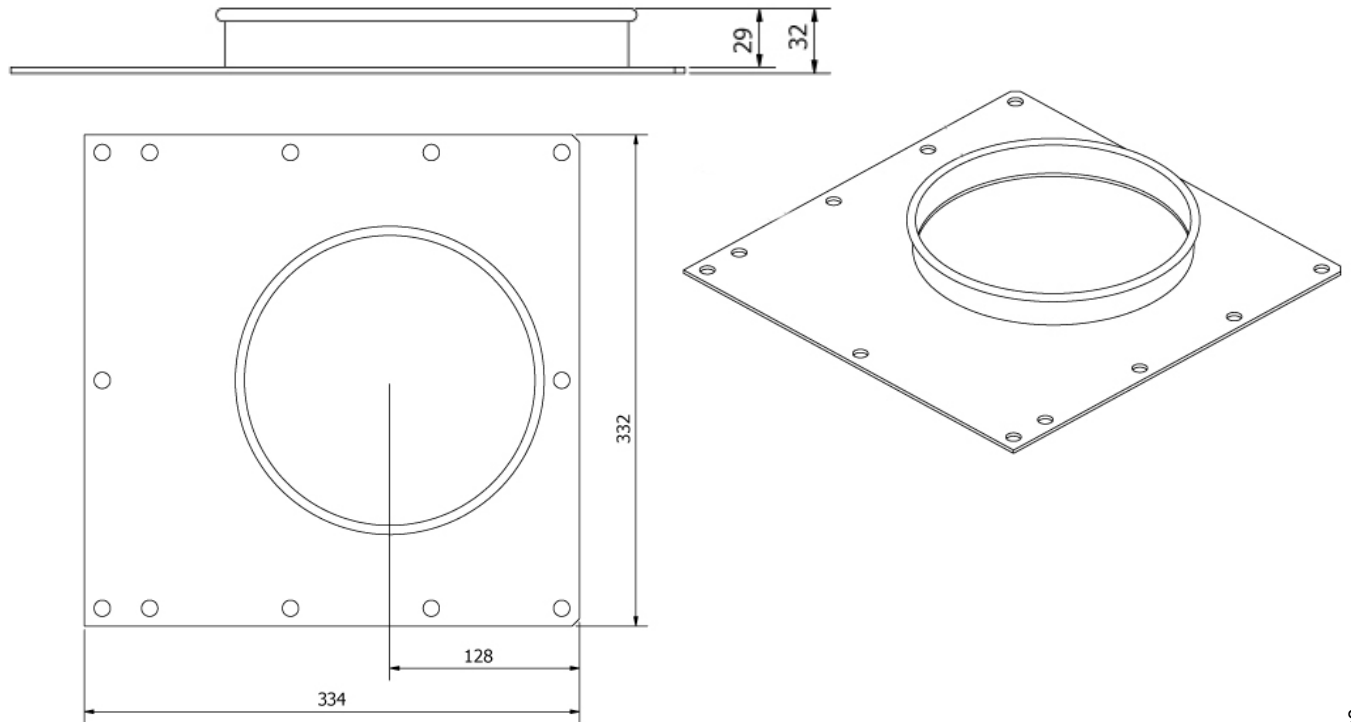

31-520

136 000 493: FK250 Inlet adaptor

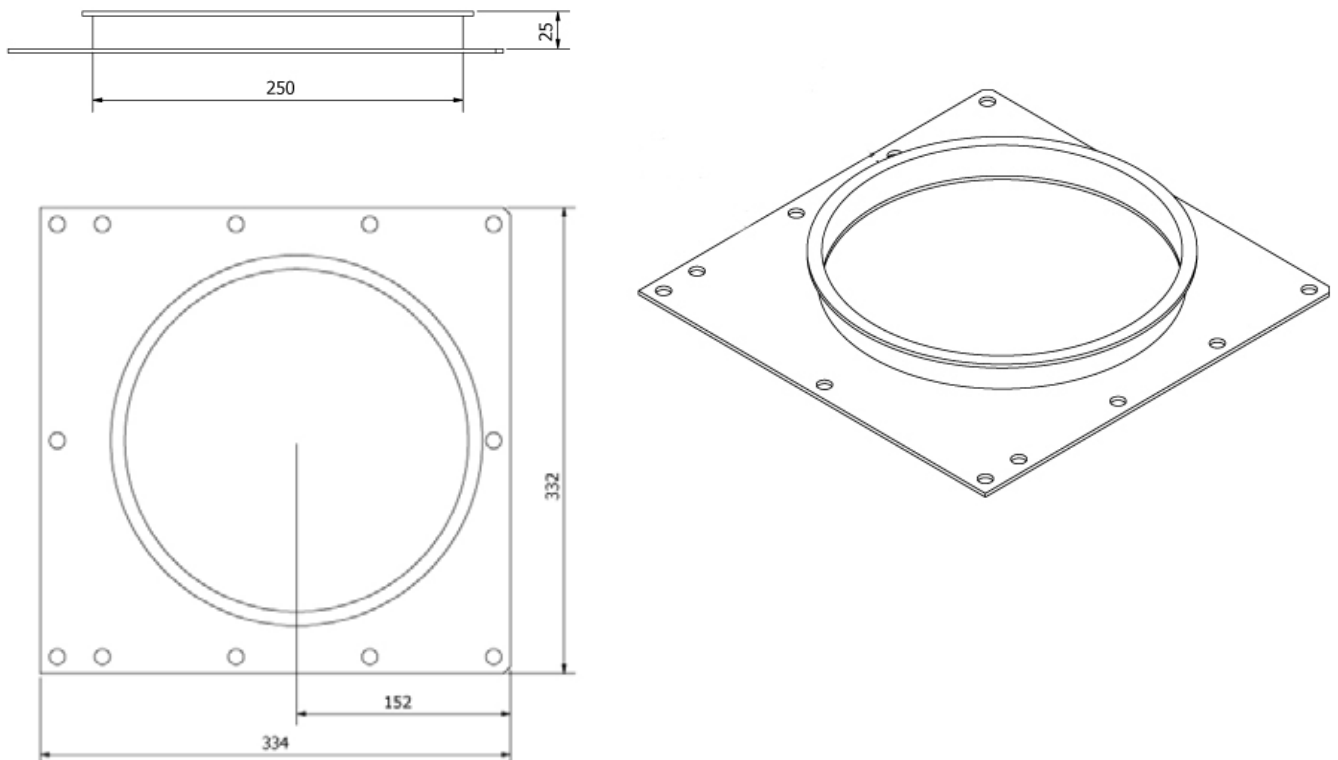

31-514

# KBE 60/80 - Accessories

136 000 422: Hopper, 2-sided

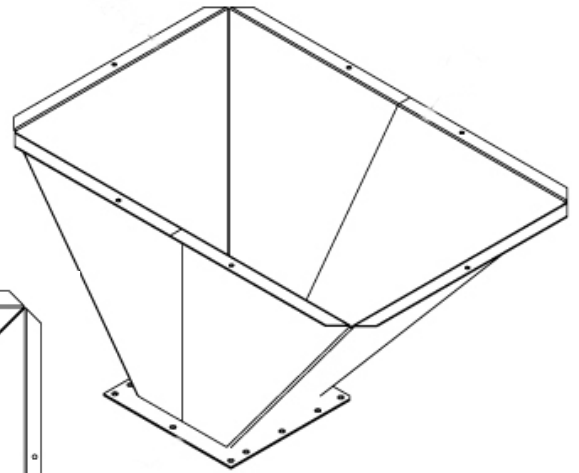
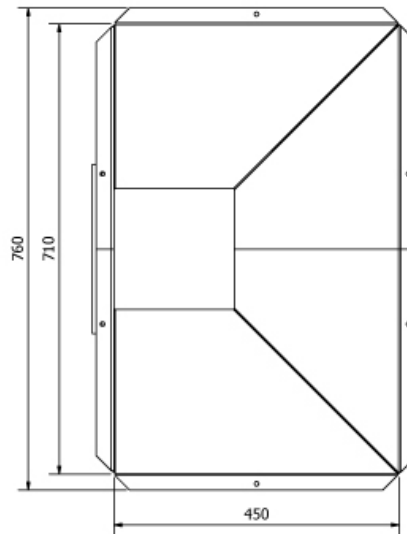
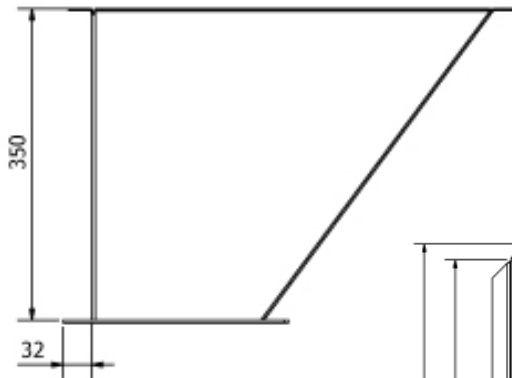

30-516

136 000 423: Hopper, right (shown)

136 000 424: Hopper, left

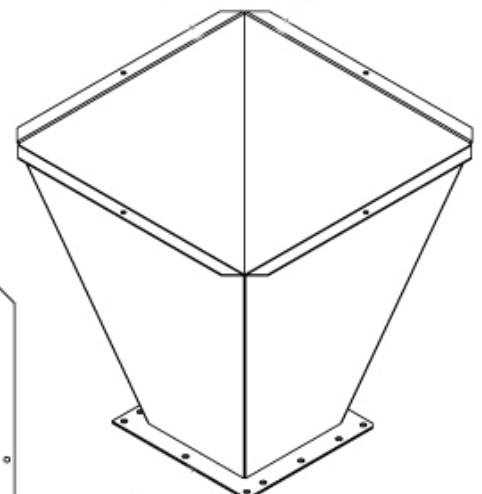
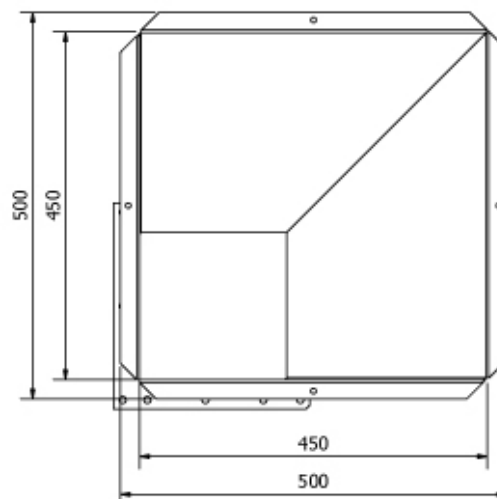
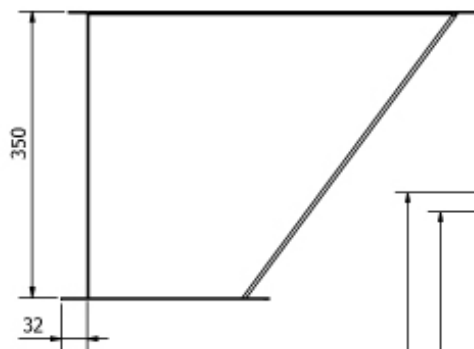

30-515



# KBE 60/80 - Accessories

136 000 426: OK200 transition, outlet adaptor

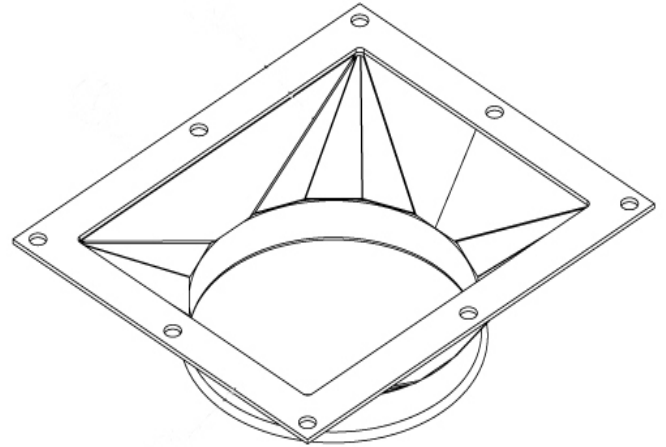
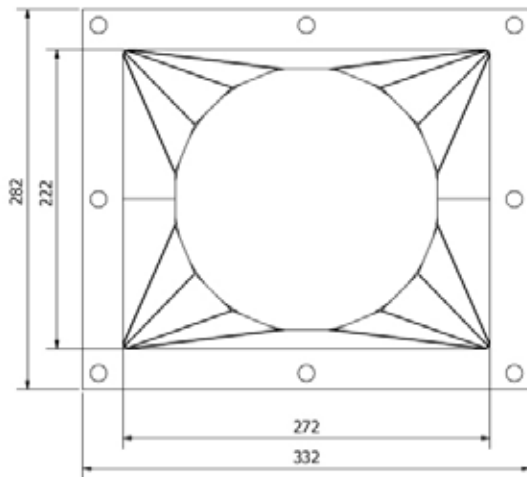
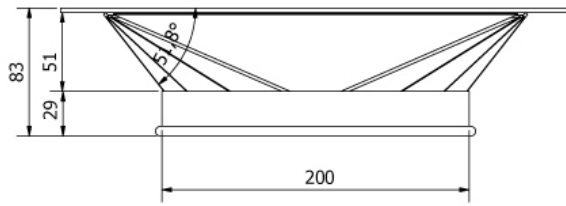

31-513

136 000 427: FK250 transition, outlet adaptor

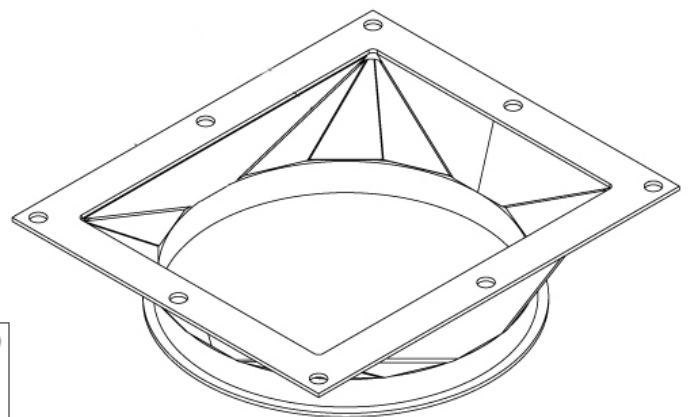
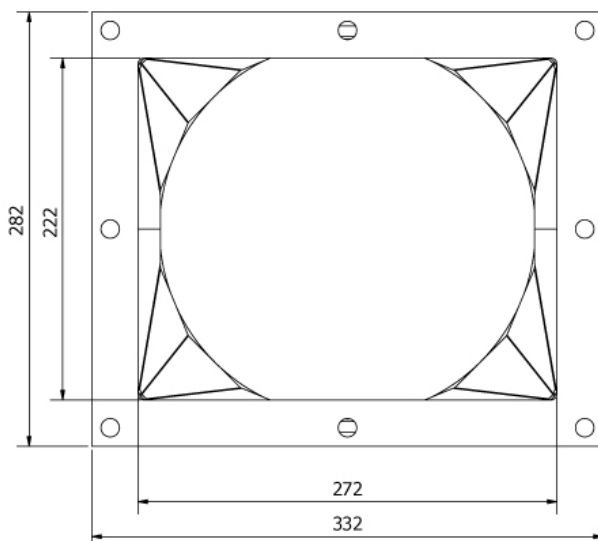
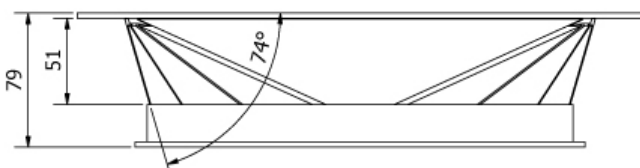

31-519

# KBE 100/120 - Accessories

136 000 462: FK250 Inlet adaptor

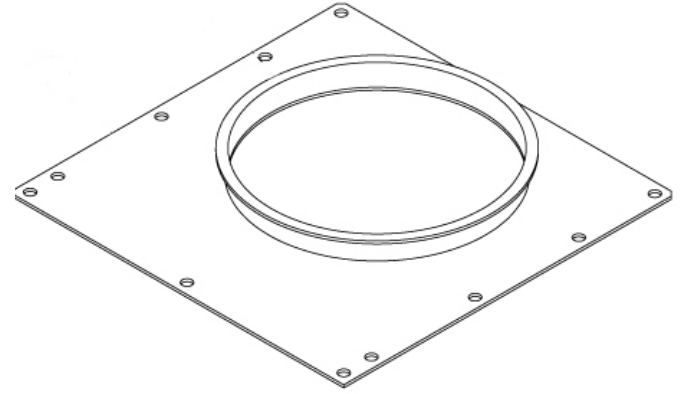
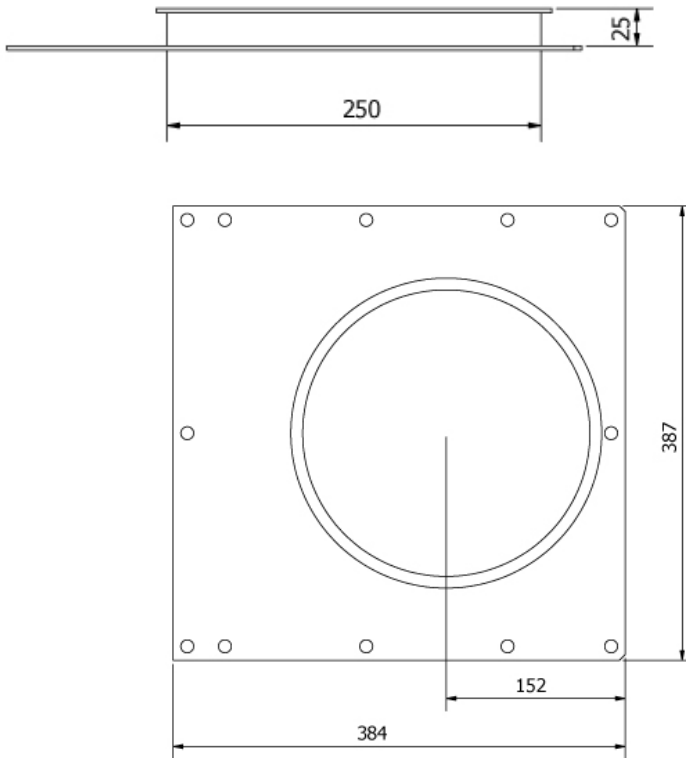

32-520

136 000 463: FK300 Inlet adaptor

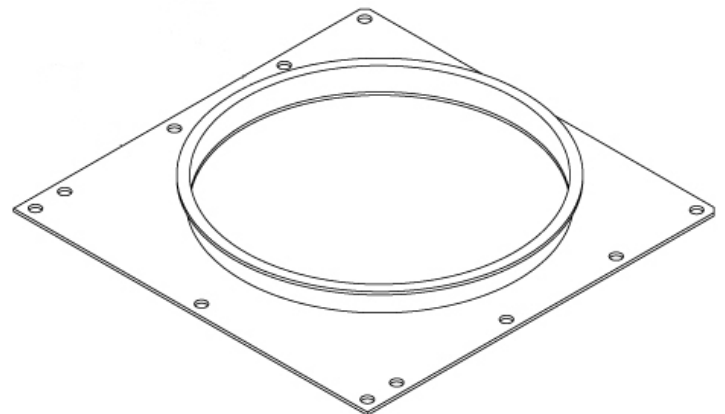
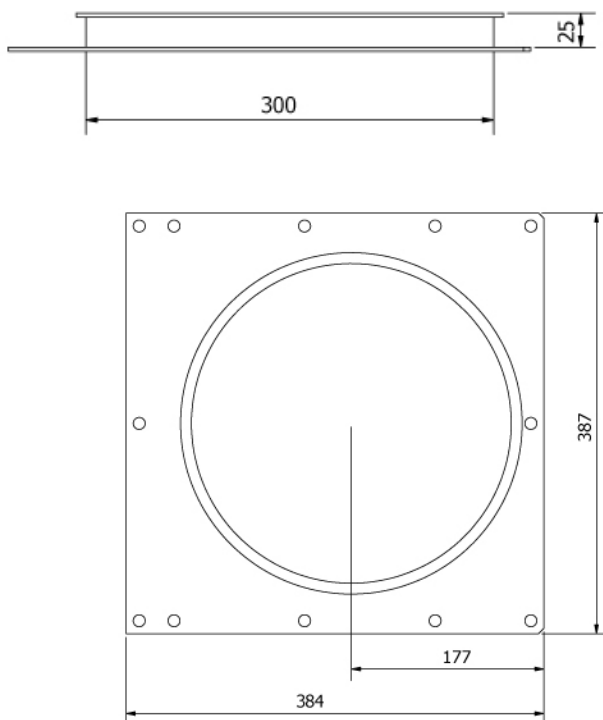

32-514

# KBE 100/120 - Accessories

136 000 464: Q24 Inlet adaptor

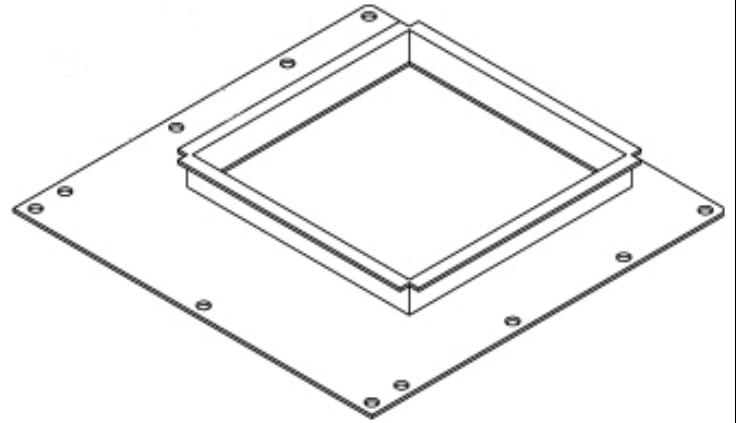
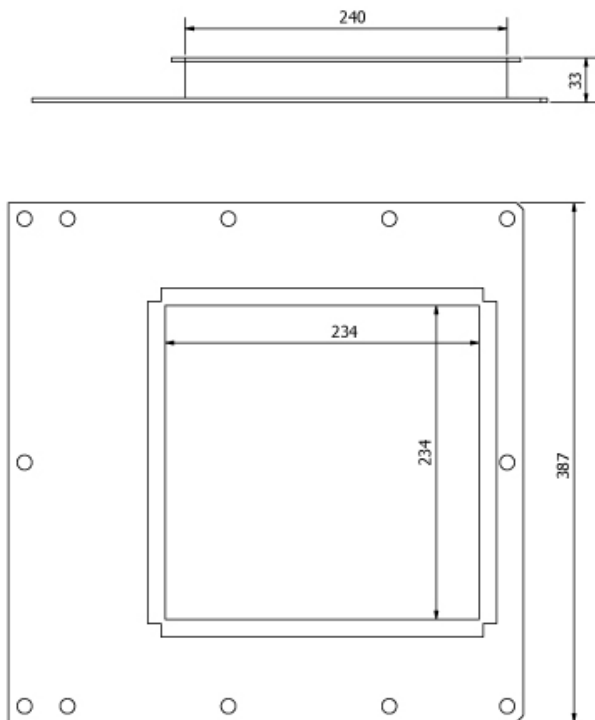

32-518

136 000 465: Q30 Inlet adaptor

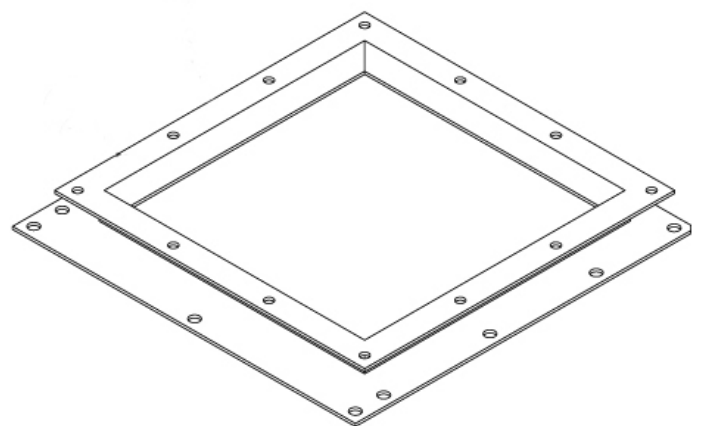
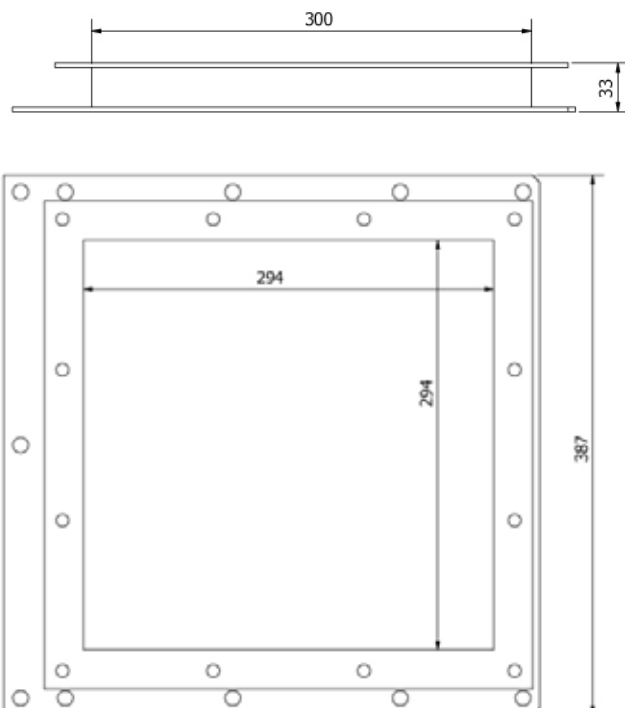

32-522

# KBE 100/120 - Accessories

136 000 466: FK250 transition, outlet adaptor

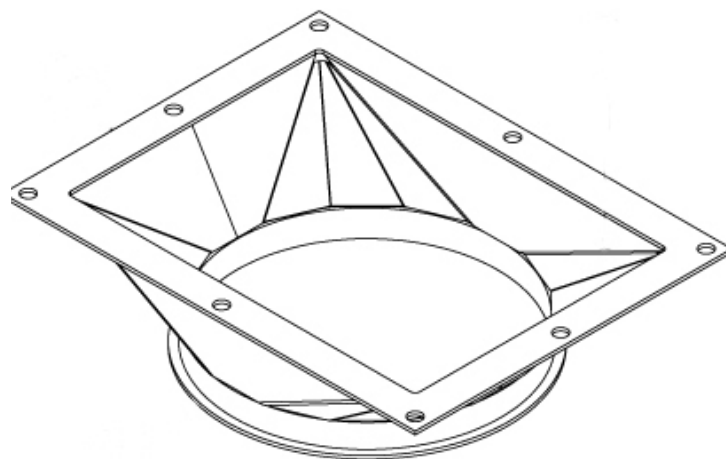
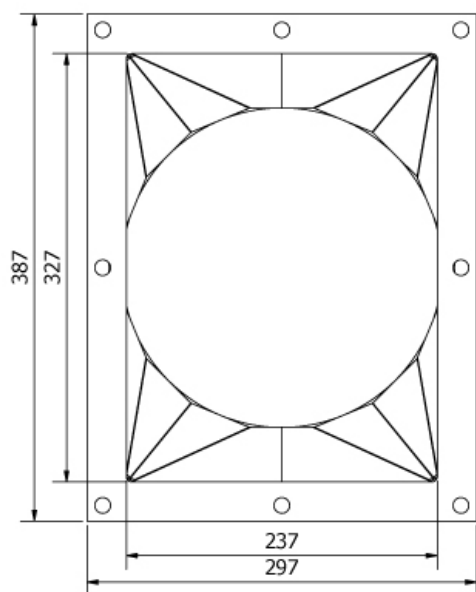
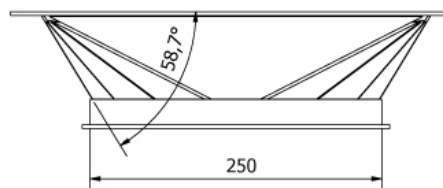
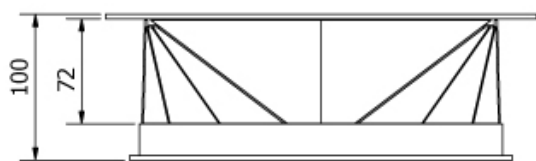

32-513

136 000 467: FK300 transition, outlet adaptor

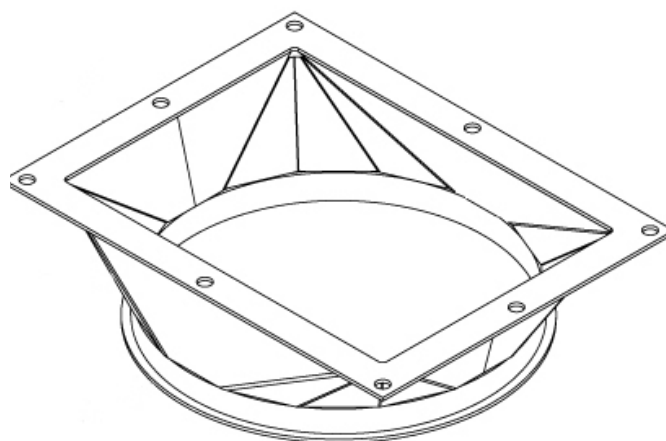
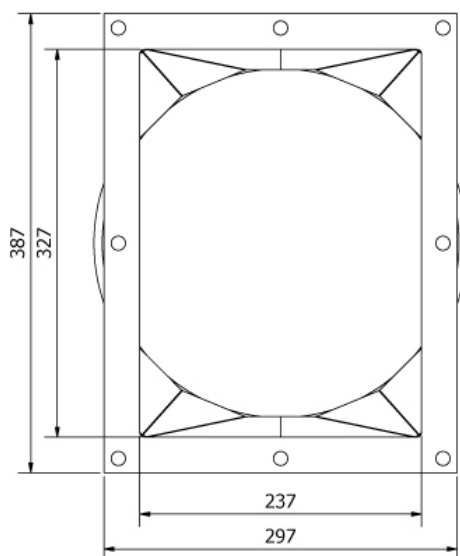
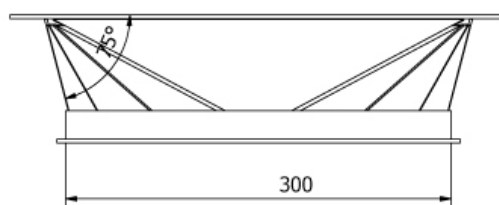
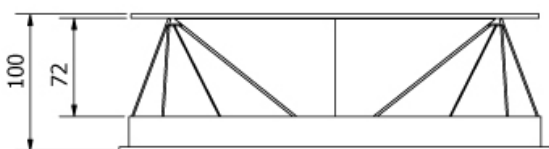

32-519

# KBE 100/120 - Accessories

136 000 468: Q24 transition, outlet adaptor

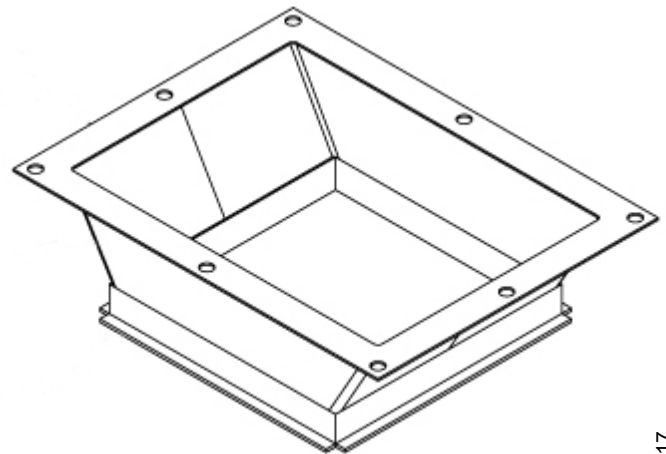
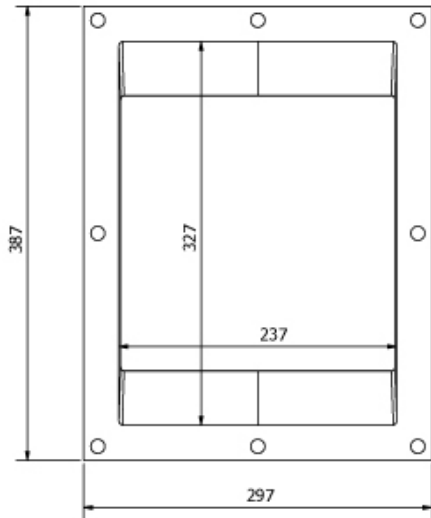
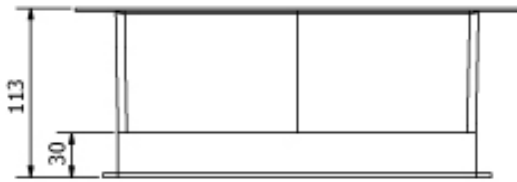

32-517

136 000 469: Q30 transition, outlet adaptor

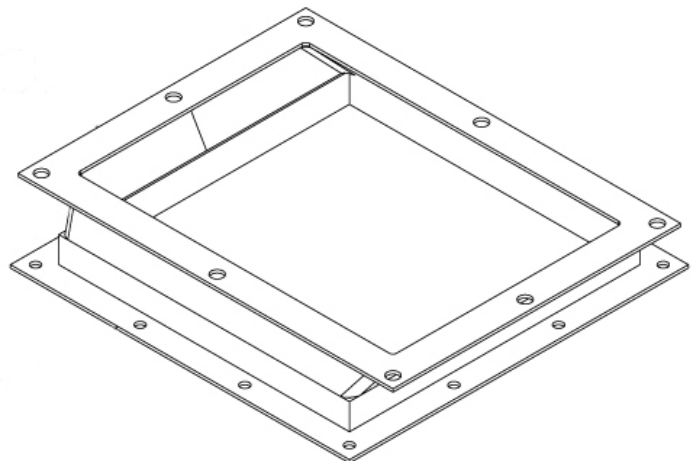
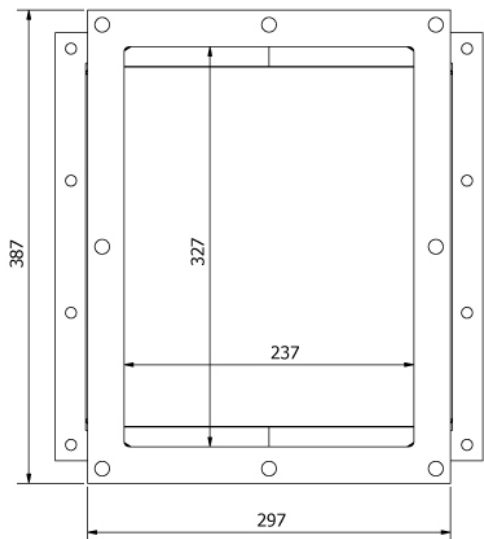
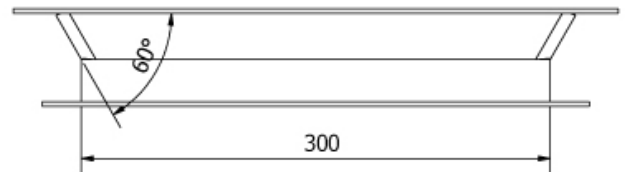
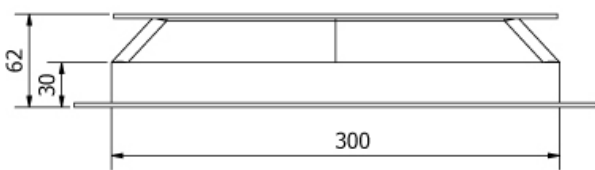

32-521







*Air solutions / your success*

**Kongskilde Industries A/S**

Skælskørvej 64

4180 Sorø

Tel. +45 72 17 60 35

[grain@kongskilde-industries.com](mailto:grain@kongskilde-industries.com)

[www.kongskilde-industries.com](http://www.kongskilde-industries.com)