

# **DGC 127 & 152**

## Grain augers

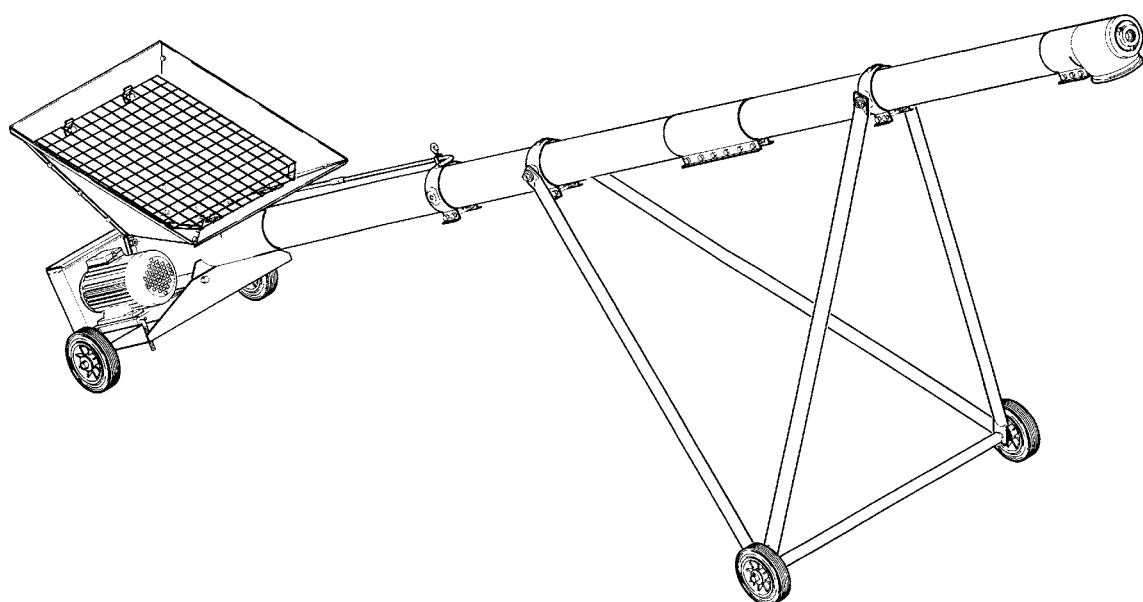

Spare parts list

Fig.	Pack	Part no.	Pieces	Notes
1	A	100 331 004	8	Flat washer M6
2	A	100 315 028	4	Nut M6
3	A	171 021 422	1	Front plate for inlet hopper
4	A	171 021 378	4	Attachment for wire grid
5	A	100 323 041	4	Set screw M6 x 16 mm
6	A	171 021 377	1	Wire grid
7	A	100 331 004	28	Flat washer M6
8	A	100 308 018	14	Set screw M6 x 12 mm
9	A	100 315 028	14	Nut M6
10	A	100 323 041	2	Set screw M6 x 16 mm
11	A	100 331 004	4	Flat washer M6
12	A	100 315 028	2	Nut M6
13	A	171 021 418	1	Side plate for inlet hopper
14	A	100 323 041	6	Set screw M6 x 16 mm
15	A	100 331 004	12	Flat washer M6
16	A	100 315 028	6	Nut M6
17	A	171 021 420	2	Guide plate for inlet shutter
18	A	171 021 386	1	Inlet shutter
19	A	100 333 009	2	Split pin ø4 x 36 mm
20	A	171 021 419	1	Back plate for inlet hopper
21	A	171 021 423	1	Side plate for inlet hopper
22	A	171 002 352	1	Extension for control rod
23	A	100 323 301	1	Ring bolt M8 x 30 mm
24	A	171 002 349	1	Attachment for control rod for DGC 127
25	A	171 002 159	1	Attachment for control rod for DGC 152
26	A	171 002 346	1	Control rod
27	A	100 414 041	1	Plastic plug
29	A	171 021 398	1	Clamp for control rod for DGC 127
30	A	171 021 399	1	Clamp for control rod for DGC 152
31	A	100 315 012	1	Nut M8
32	A	100 315 012	2	Nut M8 for DGC 127
33	A	100 315 013	2	Nut M10 for DGC 152
34	A	100 331 005	4	Flat washer M8 for DGC 127
35	A	100 331 006	4	Flat washer M10 for DGC 152
36	A	100 308 032	2	Set screw M8 x 35 mm for DGC 127
37	A	100 308 037	2	Set screw M10 x 40 mm for DGC 152
41	B	171 404 307	1	Outside belt guard for DGC 127
42	B	171 405 307	1	Outside belt guard for DGC 152
44	B	100 403 090	2	V-belt SPZ 950 for DGC 127
45	B	100 403 108	2	V-belt SPZ 1060 for DGC 152
46	B	100 331 005	2	Flat washer M8
47	B	100 306 014	2	Set screw M8 x 15 mm
48	B	100 323 303	2	Clips nut M8
49	B	100 306 015	1	Set screw M8 x 20 mm
50	B	100 331 076	1	Flat washer ø30/8 mm
51	B	100 322 023	2	Stop screw M8
52	B	170 030 320	1	V-belt pulley SPZ 140 with 2 grooves
53	B	170 030 354	1	V-belt pulley SPZ 180 with 2 grooves
54	B	170 030 364	1	V-belt pulley SPZ 200 with 2 grooves
55	B	100 331 006	8	Flat washer M10
56	B	100 315 013	4	Nut M10
57	B	100 331 004	8	Flat washer M6
58	B	100 308 018	4	Set screw M6 x 12 mm
60	B	171 404 309	1	Inside belt guard for DGC 127
61	B	171 405 308	1	Inside belt guard for DGC 152
62	B	171 003 416	1	Spacer
63	B	100 315 013	2	Nut M10
64	B	100 331 006	4	Flat washer M10
65	B	171 001 301	1	Motor mounting plate for DGC 127
66	B	171 004 301	1	Motor mounting plate for DGC 152
67	B	100 315 028	4	Nut M6
68	B	100 306 030	4	Set screw M10 x 30 mm
69	B	100 308 026	2	Set screw M6 x 30 mm for DGC 127
70	B	100 308 032	2	Set screw M8 x 35 mm for DGC 152
71	B	100 331 004	8	Flat washer M6 for DGC 127
72	B	100 331 005	8	Flat washer M8 for DGC 152
73	B	100 331 008	4	Flat washer M16 for DGC 127
74	B	100 331 009	4	Flat washer M20 for DGC 152
77	B	171 021 415	2	Wheel for DGC 127
78	B	100 412 001	2	Wheel for DGC 152
79	B	100 333 076	2	Split pin ø3.2 x 25 mm for DGC 127
80	B	100 333 009	2	Split pin ø4 x 36 mm for DGC 152
81	B	100 315 028	4	Nut M6 for DGC 127
82	B	100 315 012	4	Nut M8 for DGC 152
83	B	171 401 324	2	Wheel axle for DGC 127

Fig.	Pack	Part no.	Pieces	Notes
84	B	171 405 311	2	Wheel axle for DGC 152
85	B	100 308 004	2	Set screw M10 x 20 mm
86	B	100 315 013	4	Nut M10
87	B	100 331 006	6	Flat washer M10
88	B	170 022 101	2	Stretching screw M10
90	B	100 333 076	2	Split pin ø3.2 x 25 mm
91	B	100 315 013	2	Nut M10
92	B	100 332 020	2	Star washer M10
93	B	170 022 100	2	Stud bolt M10
94	B	100 306 031	2	Set screw M10 x 35 mm
95	B	100 315 013	2	Nut M10
96	B	100 331 006	4	Flat washer M10
97	B	100 308 004	2	Set screw M10 x 20
98	B	100 331 006	2	Flat washer M10
99	B	100 315 013	2	Nut M10
100	B	171 404 308	1	Base plate for DGC 127
101	B	171 405 309	1	Base plate for DGC 152
103	B	100 316 003	2	Lock nut M8
105	B	100 331 005	4	Flat washer M8
107	B	100 331 074	4	Dished washer M8
109	B	171 003 415	1	Shaft
111	B	100 309 009	2	Hex-socket cap screw M8 x 55 mm
113	B	100 405 000	1	Key 8 x 7 x 35 mm for DGC 127
115	B	171 003 126	1	565 mm flight for DGC 127
116	B	171 004 424	1	565 mm flight for DGC 152
121	C	100 309 004	3	Hex-socket cap screw M8 x 16 mm
123	C	100 332 019	3	Star washer M8
125	C	100 315 012	3	Nut M8 for DGC 127
127	C	171 021 132	1	Oblong inlet for DGC 127
128	C	171 021 137	1	Oblong inlet for DGC 152
130	C	171 003 301	1	Bearing cap
132	C	100 401 063	1	Ball bearing # 6305
134	C	100 331 005	3	Flat washer M8 for DGC 127
135	C	100 308 037	3	Flat washer M10 for DGC 152
136	C	100 308 032	3	Set screw M8 x 35 mm for DGC 127
137	C	100 308 037	3	Set screw M10 x 40 mm for DGC 152
138	C	100 315 012	3	Nut M8 for DGC 127
139	C	100 315 013	3	Nut M10 for DGC 152
150	D	100 322 023	1	Stop screw M8
152	D	170 030 252	1	V-belt pulley SPZ 100 with 2 grooves, bore ø28 mm
163	E	171 003 311	1	1 m pipe for DGC 127, galvanized
164	E	171 003 312	1	2 m pipe for DGC 127, galvanized
165	E	171 003 313	1	3 m pipe for DGC 127, galvanized
166	E	171 004 311	1	1 m pipe for DGC 152, blue
167	E	171 004 312	1	2 m pipe for DGC 152, blue
168	E	171 004 313	1	3 m pipe for DGC 152, blue
172	E	171 003 156	1	1 m flight for DGC 127
173	E	171 003 158	1	2 m flight for DGC 127
174	E	171 003 160	1	3 m flight for DGC 127
175	E	171 004 421	1	1 m flight for DGC 152
176	E	171 004 422	1	2 m flight for DGC 152
177	E	171 004 423	1	3 m flight for DGC 152
179	E	100 309 007	1	Hex-socket cap screw M8 x 45 mm
181	E	100 331 005	2	Flat washer M8
183	E	100 316 003	1	Lock nut M8
191	F	171 003 210	1	Joining clamp for DGC 127
192	F	171 004 210	1	Joining clamp for DGC 152
194	F	100 315 012	6	Nut M8 for DGC 127
195	F	100 315 013	6	Nut M10 for DGC 152
196	F	100 331 005	12	Flat washer M8 for DGC 127
197	F	100 331 006	12	Flat washer M10 for DGC 152
198	F	100 308 034	6	Set screw M8 x 45 mm for DGC 127
199	F	100 308 037	6	Set screw M10 x 40 mm for DGC 152
201	G	100 309 007	1	Hex-socket cap screw M8 x 45 mm
203	G	100 331 005	2	Flat washer M8
205	G	100 316 003	1	Lock nut M8
207	G	171 003 418	1	Shaft
209	G	171 404 103	1	Discharge outlet for DGC 127
210	G	171 405 103	1	Discharge outlet for DGC 152
212	G	100 401 063	1	Ball bearing # 6305
214	G	171 003 301	1	Bearing cap
216	G	100 309 004	3	Hex-socket cap screw M8 x 16 mm
218	G	100 332 019	3	Star washer M8
220	G	100 315 012	3	Nut M8
221	G	100 315 012	3	Nut M8 for DGC 127

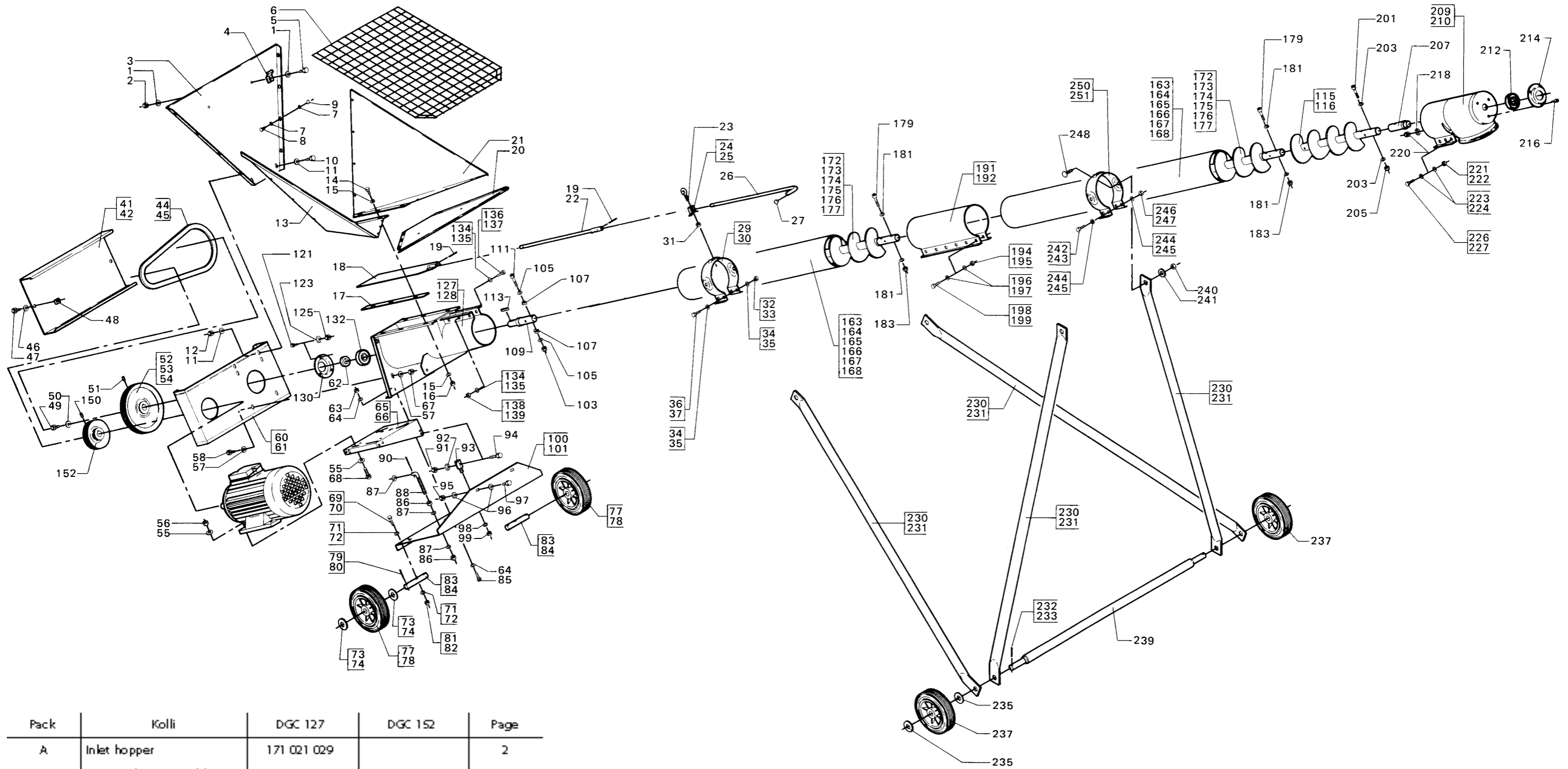

Pack	Kolli	DGC 127	DGC 152	Page
A	Inlet hopper	171 021 029		2
B	Bottom drive assembly	171 404 008	171 405 003	2/3
C	Oblong inlet	171 021 134	171 021 138	3
D	V-belt pulley, 3-5.5 HP	170 030 252	170 030 252	3
E	1m flight extension	171 003 011	171 004 011	3
E	2m flight extension	171 003 012	171 004 012	3
E	3m flight extension	171 003 013	171 004 013	3
F	Joining clamp	171 003 210	171 004 210	3
G	Discharge outlet	171 404 007	171 405 007	3/6
H	Adjustable trolley	171 021 017	171 021 018	6



**Kongskilde Industries A/S**

Skælskørvej 64

DK - 4180 Sorø

Tel. +45 72 17 60 00

[mail@kongskilde-industries.com](mailto:mail@kongskilde-industries.com)

[www.kongskilde-industries.com](http://www.kongskilde-industries.com)